

# The Blyton

Three bedroom home

Plots 115, 116, 123 & 124



Computer generated image based on plot 1 & 2

Wickfields,  
Barn Road, Longwick,  
Buckinghamshire  
HP27 9RW

Telephone: 0333 202 5172  
[www.bellway.co.uk](http://www.bellway.co.uk)

**Bellway**

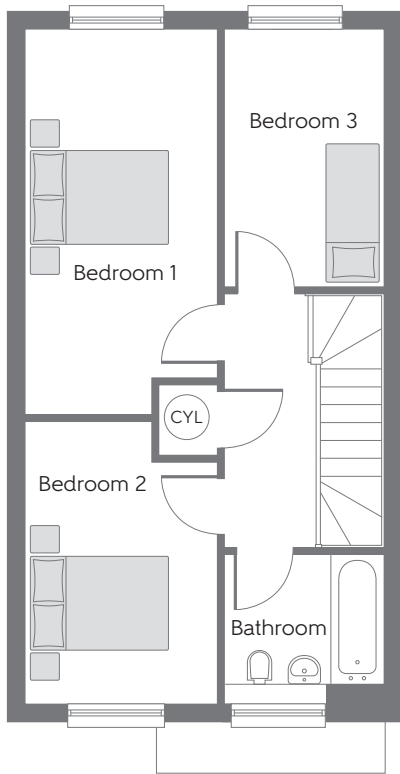

**First Floor**

Bedroom 1	5.09m x 2.54m	16'9" x 8'4"
Bedroom 2	3.74m x 2.54m	12'3" x 8'4"
Bedroom 3	3.40m x 2.10m	11'2" x 6'11"

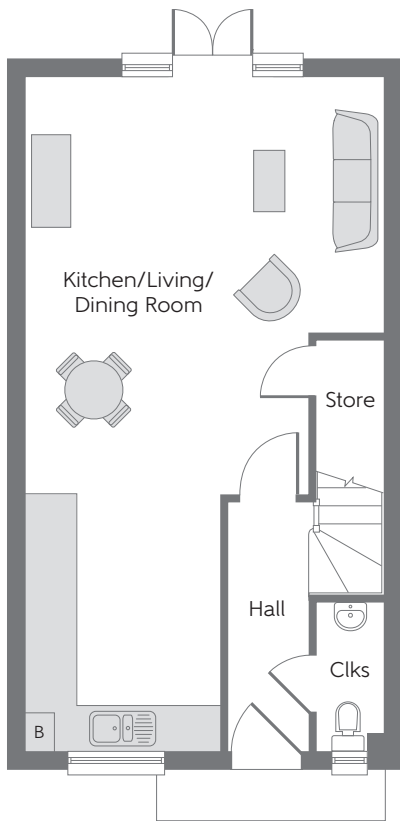

**Ground Floor**

Kitchen/Living/ Dining Room	8.90m x 4.73m	29'3" x 15'6"
--------------------------------	---------------	---------------

Total Internal Area    84 sq. m.            905 sq. ft.

Please refer to site plan for individual garage layouts.

**B** Boiler    **CYL** Hot Water Cylinder    Clks Cloakroom

Some items shown in this key may be subject to change, and positions could vary from those indicated on this floorplan. Please refer to Sales Advisor for details of your selected plot. Computer generated image shown overleaf. External finishes, landscaping and configuration may vary from plot to plot. Please refer to Sales Advisor for further details. All dimensions are approximate and should not be used for carpet sizes, appliance spaces or furniture. Furniture not to scale and all positions are indicative. We operate a policy of continuous improvement and individual features such as kitchen and bathroom layouts, doors, windows, garages and elevational treatments may vary from time to time. Consequently these particulars should be treated as general guidance only and do not constitute a contract, part of a contract or a warranty. Type B (H324). 217610/02/21.