

The Cypress

Two bedroom mews home



Bellway

The Cypress

Two bedroom mews home

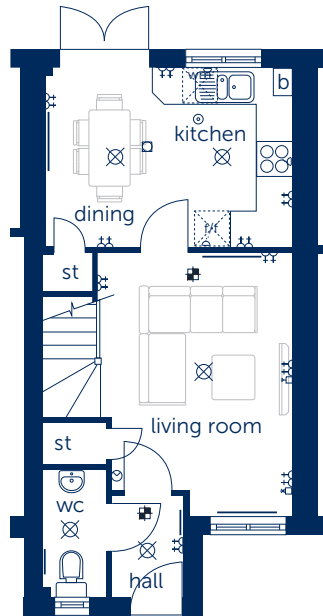

Ground Floor

Kitchen/Dining	4.165m x 3.000m	13'8" x 9'10"
Living Room	3.269m x 4.435m	10'9" x 14'7"

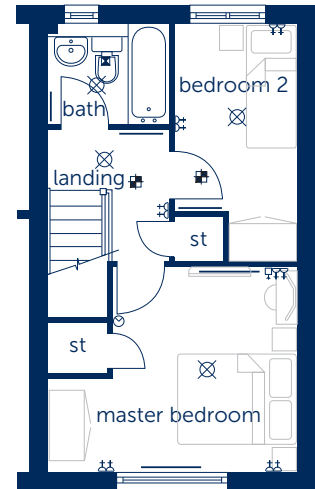

First Floor

Master Bedroom	3.180m† x 3.468m	10'5"† x 11'5"
Bedroom 2	2.117m x 3.150m†	6'11" x 10'4"†

† minimum dimensions

- heat detector
- ⊕ thermostat
- ⊞ TV aerial outlet
- ⊞ extractor fan
- ⊞ boiler
- ⊞ smoke detector
- ⊞ low level socket
- ⊞ St cupboard
- ⊞ hot water cylinder
- ⊞ outside light
- ⊞ ceiling light
- ⊞ double socket
- ⊞ e/s en-suite
- ⊞ wm washing machine space
- ⊞ carbon monoxide detector
- ⊞ telephone point
- radiator
- ⊞ f/f fridge freezer space

Some items shown in this key may be subject to change, and positions could vary from those indicated on this floorplan. Please refer to Sales Advisor for details of your selected plot.

Computer generated image shown overleaf. External finishes, landscaping and configuration may vary from plot to plot. Please refer to Sales Advisor for further details. All dimensions are approximate and should not be used for carpet sizes, appliance spaces, or furniture. Furniture not to scale and all positions are indicative. Wardrobes are shown to suggest position only, and are not included as standard unless otherwise stated. We operate a policy of continuous improvement and individual features such as kitchen and bathroom layouts, doors, windows, garages and elevational treatments may vary from time to time. Consequently these particulars should be treated as general guidance only and do not constitute a contract, part of a contract or a warranty.

V1/5/14

Bellway Homes Ltd,
 (Scotland Division)
 Bothwell House,
 Hamilton Business Park,
 Caird Street, Hamilton ML3 0QA
 Telephone 01698 477440
 Fax 01698 477441
www.bellway.co.uk