

THE
Middleham
A 4 BEDROOM HOME

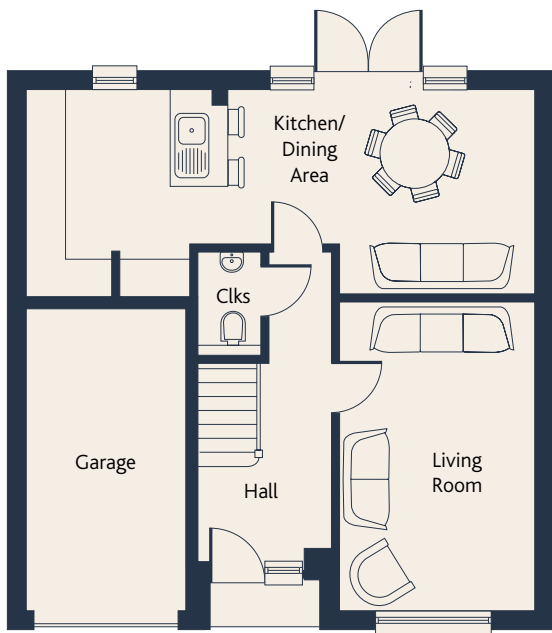

A spacious kitchen/dining area is at the heart of this four bedroom detached home while a separate living room offers a space to relax. The master bedroom benefits from an en suite.

Ground floor



First floor



Ground floor

Living Room	4.795m x 3.165m	15'8" x 10'4"
Kitchen/Dining Area	8.003m x 3.175m	26'3" x 10'5"
Cloakroom	1.600m x 0.860m	5'3" x 2'9"

First floor

Bedroom 1	4.795m x 4.113m	15'8" x 13'5"
En Suite	1.998m x 1.685m	6'6" x 5'6"
Bedroom 2	4.107m x 2.600m	13'5" x 8'6"
Bedroom 3	3.175m x 3.017m	10'5" x 9'10"
Bedroom 4	2.855m x 2.075m	9'4" x 6'9"
Bathroom	2.075m x 1.880m	6'9" x 6'2"

Clks Cloakroom W Fitted Wardrobe CYL Hot Water Cylinder

Some items shown in this key may be subject to change, and positions could vary from those indicated on this floorplan. Please refer to Sales Advisor for details of your selected plot. Computer generated image shown on previous page. External finishes, landscaping and configuration may vary from plot to plot. Please refer to Sales Advisor for further details. All dimensions are approximate and should not be used for carpet sizes, appliance spaces or furniture. Furniture not to scale and all positions are indicative. Wardrobes are shown to suggest position only, and are not included as standard unless otherwise stated. We operate a policy of continuous improvement and individual features such as kitchen and bathroom layouts, doors, windows, garages and elevational treatments may vary from time to time. Consequently these particulars should be treated as general guidance only and do not constitute a contract, part of a contract or a warranty.