

The Wyvern (RP PH2) Four bedroom semi detached family home





The Wyvern ^(RP)

Four bedroom semi detached family home

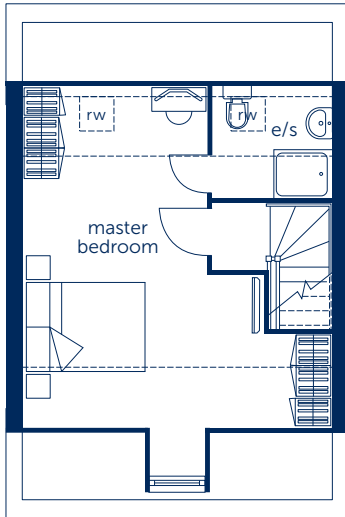

Second Floor

Master Bedroom 5.420m x 4.950m 17'9" x 16'3"
(max) (max) (max) (max)

First Floor

Bedroom 2 3.780m x 2.775m 12'5" x 9'1"
Bedroom 3 3.740m x 2.775m 12'3" x 9'1"
(max) (max)
Bedroom 4 2.760m x 2.025m 9'1" x 6'8"

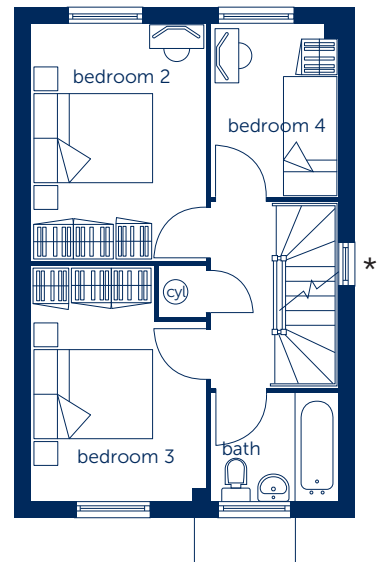

* Window to landing provided when housing allows

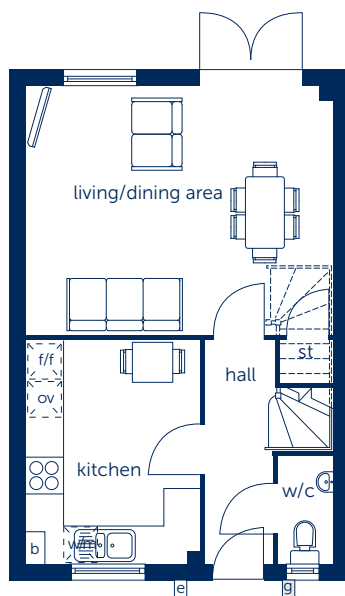

Ground Floor

Kitchen 3.550m x 2.775m 11'8" x 9'1"
Living/Dining Area 4.950m x 3.970m 16'3" x 13'0"

g gas meter st cupboard f/f integrated fridge/freezer ov integrated single oven b boiler cyl hot water cylinder
e electric meter e/s en suite w/m washing machine space rw roof window - - - reduced head height

Some items shown in this key may be subject to change, and positions could vary from those indicated on this floorplan. Please refer to Sales Advisor for details of your selected plot

Computer generated image shown overleaf. External finishes, landscaping and configuration may vary from plot to plot. Please refer to Sales Advisor for further details. All dimensions are approximate and should not be used for carpet sizes, appliance spaces, or furniture. Furniture not to scale and all positions are indicative. Wardrobes are shown to suggest position only, and are not included as standard unless otherwise stated. We operate a policy of continuous improvement and individual features such as kitchen and bathroom layouts, doors, windows, garages and elevational treatments may vary from time to time. Consequently these particulars should be treated as general guidance only and do not constitute a contract, part of a contract or a warranty. RP/PH2/01/17

Bellway Homes Ltd,
(West Midlands Division)
Bellway House, Relay Point,
Relay Drive, Tamworth,
Staffordshire B77 5PA
Telephone 01827 255755
Fax 01827 255766
www.bellway.co.uk