

# The Maidstone

Three bedroom mews home



# The Maidstone

Three bedroom mews home

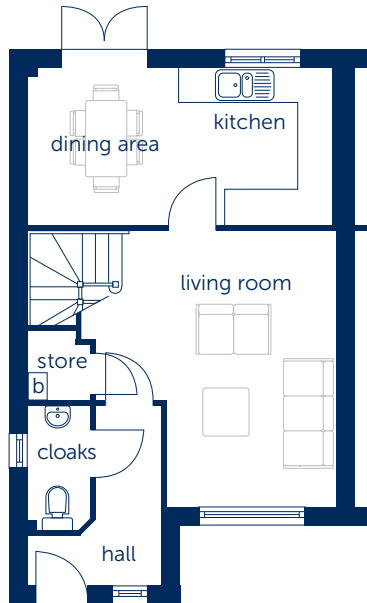

## Ground Floor

|                     |                  |               |
|---------------------|------------------|---------------|
| Kitchen/Dining Area | 5.226m x 2.697m  | 17'2" x 8'10" |
| Living Room         | 2.907m† x 4.738m | 9'6"† x 15'7" |

† minimum dimensions

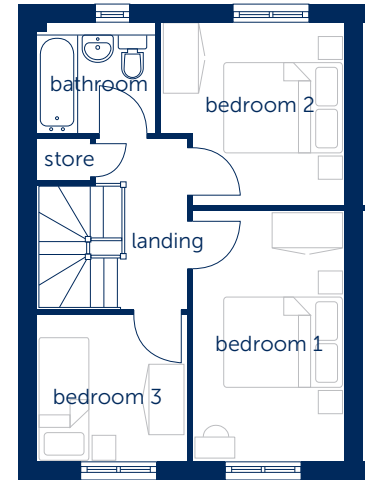

## First Floor

|           |                 |               |
|-----------|-----------------|---------------|
| Bedroom 1 | 2.597m x 4.313m | 8'6" x 14'2"  |
| Bedroom 2 | 3.150m x 3.136m | 10'4" x 10'3" |
| Bedroom 3 | 2.579m x 2.519m | 8'6" x 8'3"   |

**b** boiler

Some items shown in this key may be subject to change, and positions could vary from those indicated on this floorplan. Please refer to Sales Advisor for details of your selected plot.

Computer generated image shown. External finishes, landscaping and configuration may vary from plot to plot. Please refer to Sales Advisor for further details. Photo Voltaic (solar) panels are shown for illustrative purposes only and position and size may vary. Please refer to Sales Advisor for exact details. All dimensions are approximate and should not be used for carpet sizes, appliance spaces, or furniture. Furniture not to scale and all positions are indicative. Wardrobes are shown to suggest position only, and are not included as standard unless otherwise stated. We operate a policy of continuous improvement and individual features such as kitchen and bathroom layouts, doors, windows, garages and elevational treatments may vary from time to time. Consequently these particulars should be treated as general guidance only and do not constitute a contract, part of a contract or a warranty. V1/06/17

Bellway Homes Ltd,  
(Scotland Division)  
Bothwell House,  
Hamilton Business Park,  
Caird Street, Hamilton ML3 0QA  
Telephone 01698 477440  
Fax 01698 477441  
[www.bellway.co.uk](http://www.bellway.co.uk)